



**STUART
CHARLES**
ESTATE AGENTS



Wansford Place

, Corby, NN17 2QE

£110,000



Wansford Place

, Corby, NN17 2QE

£110,000



Entrance Hall

Entered via a double glazed door, radiator.

Lounge

16'2" x 11'8" (4.95 x 3.56)

Double glazed window to rear elevation, radiator, tv point, door to;

Kitchen

9'1" x 5'4" (2.79 x 1.65)

Fitted to comprise a range of base and eye level units with a single sink and drainer, electric oven and hob, space for automatic washing machine, space for fridge/freezer, double glazed window to side elevation.

Bathroom

8'10" x 7'6" (2.7 x 2.3)

Fitted to comprise a three piece suite consisting of a panel bath with overhead shower, low level pedestal, low level wash hand basin, radiator, double glazed window to front elevation.

Bedroom One

11'8" x 10'0" (3.56 x 3.05)

Double glazed window to rear elevation, radiator.

Boiler room

Wall mounted combi boiler.

Outside

A communal garden stretches around the whole building, a secure brick built storage shed is located in a communal storage area.



Road Map



Hybrid Map



Terrain Map

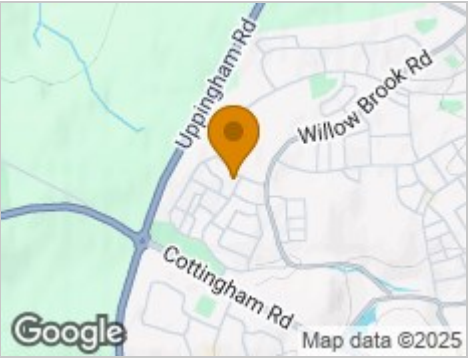

Floor Plan

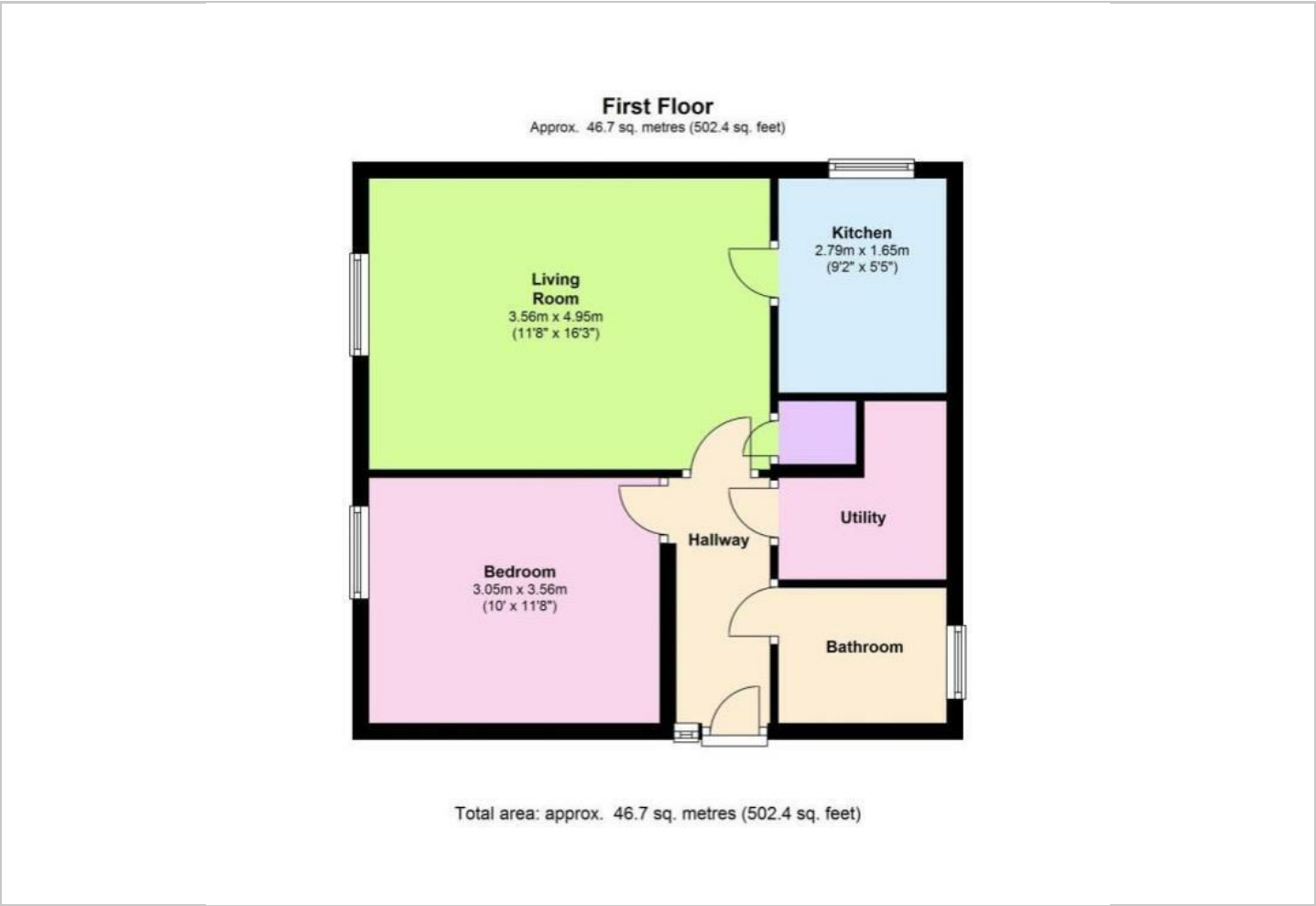

Viewing

Please contact our Stuart Charles Estate Agents Office on 01536 234264 if you wish to arrange a viewing appointment for this property or require further information.

Energy Efficiency Graph

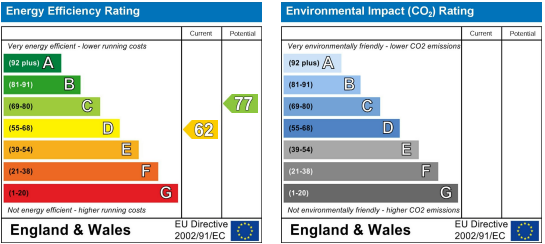

These particulars, whilst believed to be accurate are set out as a general outline only for guidance and do not constitute any part of an offer or contract. Intending purchasers should not rely on them as statements of representation of fact, but must satisfy themselves by inspection or otherwise as to their accuracy. No person in this firms employment has the authority to make or give any representation or warranty in respect of the property.